

# Installation Instructions

Instrucciones de Instalación / Instructions d'installation /  
Installationsanleitung / Istruzioni per l'installazione

TRIPP LITE  
SERIES

## Industrial Faceplates

Models:

N206-FP01-IND (1 Cutout)

N206-FP02-IND (2 Cutouts)

N206-FP04-IND (4 Cutouts)

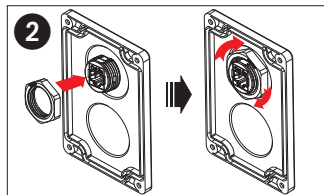
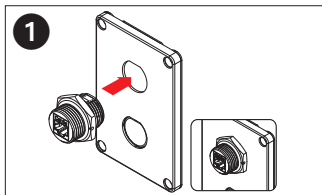

### Note:

For use with Tripp Lite series Bulkhead Couplers and Keystone Jacks, including:

- N206-BC01-IND (Cat5e/6 Bulkhead Coupler)
- N206-KJ01-IND (Keystone Jack)
- U325-000-IND (USB 3.2 Coupler)
- P569-000-FF-IND (4K HDMI Coupler)
- N455-BC01-IND (Multimode Fiber LC/LC Coupler)



Powering Business Worldwide

Eaton  
1000 Eaton Boulevard  
Cleveland, OH 44122  
United States  
Eaton.com

© 2025 Eaton  
All Rights Reserved  
Publication No. 24-11-054 /  
93-490A\_RevA  
March 2025

Eaton is a registered  
trademark.

All trademarks are property  
of their respective owners.