

Owner's Manual

2-Port USB-C KVM Docking Station

4K @ 30 Hz, USB 3.2 Gen 1

Model: B003-HC2-DOCK1

Este manual esta disponible en español en la página
deTripp Lite: triplite.com/support

Ce manuel est disponible en français sur le site Web
deTripp Lite : triplite.com/support

Русскоязычная версия настоящего руководства представлена на
веб-сайте компании Tripp Lite по адресу: triplite.com/support

WARRANTY REGISTRATION

Register your product today and be
automatically entered to win an ISOBAR®
surge protector in our monthly drawing!

triplite.com/warranty



1111 W. 35th Street, Chicago, IL 60609 USA • triplite.com/support

Copyright © 2020 Tripp Lite. All rights reserved.

USB Type-C™ and USB-C™ are trademarks of USB Implementers Forum

Package Contents

- 2-Port USB-C KVM Docking Station
- (x2) USB-C to USB-C Cables (M/M), 3.3 ft. (1 m)
- Remote Port Selector
- Owner's Manual

Optional Accessories

- P569-XXX-CERT Series High-Speed HDMI Cables
- M100-Series USB-A to Lightning Sync/Charge Cables
- U428-Series USB 3.1 Gen 1 USB-A to USB-C Cables

System Requirements

- Windows® 10 and above, computer with USB-C port and USB-C DisplayPort Alternate Mode
Note: With Intel 7th-gen Core Processor (Kaby-Lake) and above. More info about CPU generation, please reference <https://www.intel.com/content/www/us/en/processors/processor-numbers.html>
- Mac® OS X 10.12 and above, computer with USB-C port
- Android™ 8.0 and above, smartphone with USB-C port and USB-C DisplayPort Alternate Mode
Note: Only Samsung and Huawei® support PC-like operation. Others only support mirror mode. Apple® iPhones are not supported.
- iOS 12.1 and above, iPad Pro® 3rd generation (2018)
Note: For better HID experience, iPad OS 13 and above is recommended.

Supporting Mobile Devices

Samsung	Huawei	HTC	LG
Galaxy S8	P20	U11	V20
Galaxy S8+	P20 Pro	U Ultra	
Galaxy S9			
Galaxy S9+			
Galaxy S10			
Galaxy S10+			
Galaxy S10e			
Galaxy Note 8			
Galaxy Note 9			

Product Features

- Allows a USB-C laptop and a USB-C smartphone* to share one monitor, keyboard and mouse, as well as USB peripherals.**
- HDMI port supports crystal-clear 4K resolutions up to 3840 x 2160 @ 30 Hz.
- Provides USB PD 3.0 for laptop/computer charging up to 85W at power profiles of 5/9/15/20V.
- Supports Samsung DeX mode and Huawei Desktop mode.***
- Video DynaSync™ allows continuous real-time switching with EDID/HDCP monitors and computers.
- Switches between ports using the included remote port selector.
- Plug-and-play operation with no extra software or external power supply required

* *Apple iPhones are not supported.*

** *For video output to work through a USB-C port, it must support USB-C DisplayPort Alternate Mode.*

*** *Compatible with smartphones launched in 2018 or later that support USB-C DisplayPort Alternate Mode.*

Feature Identification

Front Panel

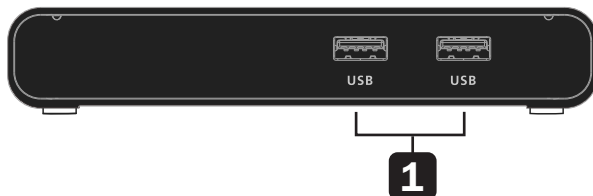

- 1 USB 3.2 Gen 1 Type-A Ports:**
Connects to USB-A peripherals, such as a keyboard, mouse or thumb drive.

Feature Identification

Rear Panel

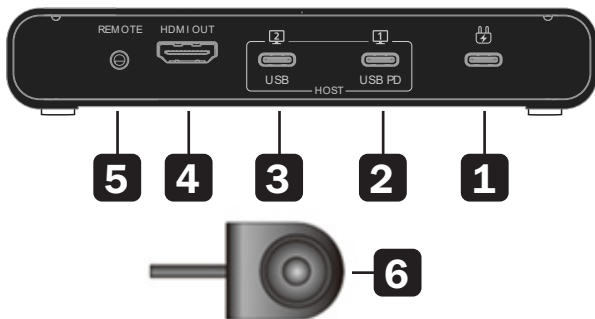

- 1 USB-C DC-In Port*:**
Connects a USB-C power source.
- 2 USB-C 3.2 Gen 1 Type-C Port 1 (Laptop)**:**
Connects a computer with the included USB-C cable.
If you need PD laptop charging, connect your computer to this port.
- 3 USB-C 3.2 Gen 1 Type-C Port 2 (Android: Samsung DeX or Huawei Desktop Mode)***:**
Connects a laptop or Android mobile device with the included USB-C cable.
- 4 HDMI Output:**
Connects to a monitor's HDMI input with a user-supplied HDMI cable.

Feature Identification

5 2.5 mm Remote Port Selector Jack:

Connects the included Remote Port Selector.

6 Remote Port Selector:

Press the button to switch to the next port when connected to the unit.

* *Supports maximum 100W USB-C PD power adapter input. For device charging, a Limited Power Source (LPS) certified USB-C PD power adapter over 65W is recommended. The minimum system power requirement for basic USB functions and video output should be at least 5V 3A. The first 15W will supply the B003-HC2-DOCK1. The next 10W will supply the USB-C device connected to the Android port. The balance of power will supply the USB-C device connected to the Laptop port.*

** *Supports USB-C PD laptop charging at 5/9/15/20V output.*

*** *Supports maximum 5V 2A output.*

Feature Identification

Top Panel

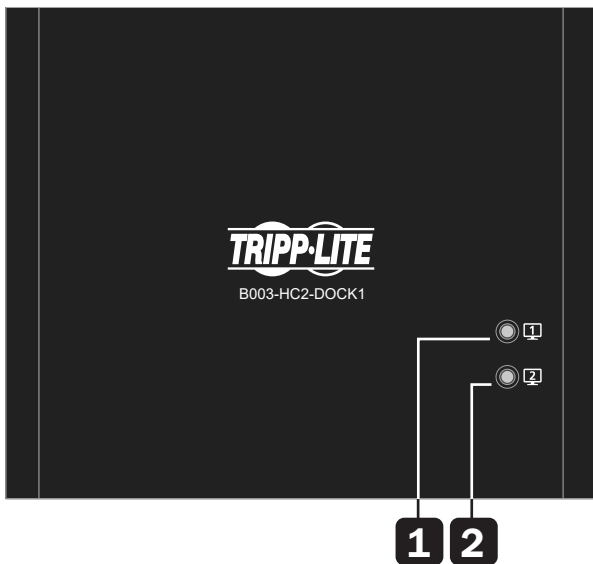

- 1 Console Indicator LED (Port 1):**
Illuminates white when the corresponding console is in use.
- 2 Console Indicator LED (Port 2):**
Illuminates white when the corresponding console is in use.

Installation and Operation



Installation and Operation

- 1** Connect a computer or laptop to Port 1 using an included USB-C cable.

Note: Port 1 supports PD 3.0 charging up to 85W at power profiles of 5/9/15/20V.

- 2** Connect a mobile device, computer or laptop to Port 2 using an included USB-C cable.

Note: Port 2 supports charging up to 10W (5V 2A). It is recommended to charge laptops using Port 1 and mobile devices, such as Android smartphones, using Port 2.

- 3** Connect an HDMI-compliant display with a user-supplied HDMI cable.

- 4 (Optional)** Connect a USB-C power adapter, such as the adapter that came with your laptop.

Note: This port supports up to 100W (20V 5A) maximum input. A USB-C PD power adapter over 65W is recommended. The first 15W will supply the B003-HC2-DOCK1 itself. The next 10W will supply the USB-C device connected to Port 2. The balance of power will supply the USB-C device connected to Port 1.

- 5** Connect up to two USB peripherals, such as thumb drives.
- 6** Connect the included Remote Port Selector.

Port Selection

Press the button on the Remote Port Selector to switch between the two connected source devices. The Console Indicator LED will illuminate to show which console port is currently in use.

Note: *If the LED begins flashing, please check the power consumption of your connected USB peripheral.*

Firmware Upgrade

- 1 Connect one end of a USB-C cable to your computer and the other end to Port 1 on the docking station.
Note: Do not connect a source to Port 2.
- 2 Connect the Remote Port Selector cable to the unit.
- 3 Press and hold the remote button, then power on the B003-HC2-DOCK1. The LED will blink and unit will enter the firmware upgrade mode.
- 4 Run the Upgrade.bat file and follow the instructions.
- 5 After a successful firmware upgrade, disconnect the power source to the B003-HC2-DOCK1 to exit the firmware upgrade mode.

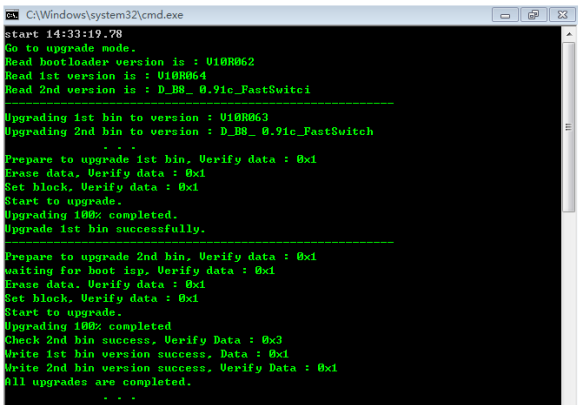

```
C:\Windows\system32\cmd.exe
start 14:33:19.78
Go to upgrade mode.
Read bootloader version is : V10R062
Read 1st version is : V10R064
Read 2nd version is : D_B8_0.91c_FastSwitch

-----
Upgrading 1st bin to version : V10R063
Upgrading 2nd bin to version : D_B8_0.91c_FastSwitch

-----
Prepare to upgrade 1st bin, Verify data : 0x1
Erase data, Verify data : 0x1
Set block, Verify data : 0x1
Start to upgrade.
Upgrading 100% completed.
Upgrade 1st bin successfully.

-----
Prepare to upgrade 2nd bin, Verify data : 0x1
waiting for boot up, Verify data : 0x1
Erase data, Verify data : 0x1
Set block, Verify data : 0x1
Start to upgrade.
Upgrading 100% completed
Check 2nd bin success, Verify Data : 0x3
Write 1st bin version success, Data : 0x1
Write 2nd bin version success, Verify Data : 0x1
All upgrades are completed.

. . .
```

Specifications

Model			B003-HC2-DOCK1
Device Connection			2
Connectors	Upstream	Computer	(x1) USB 3.2 Gen 1 Type-C (Female)
		Smartphone	(x1) USB 3.2 Gen 1 Type-C (Female)
	Downstream	USB	(x2) USB 3.2 Gen 1 Type-C (Female)
		HDMI	(x1) HDMI (Female)
Source Selection			(x1) 2.5 mm
LED			(x2) White
Video		Max Res	3840 x 2160 @ 30 Hz
		Compliance	USB 3.2 Gen 1 Type-C with DisplayPort Alt Mode (Thunderbolt 3 Compatible); HDCP 1.4
Power Delivery		Port 1	USB PD 3.0 for laptop charging up to 85W; power profiles include 5/9/15/20V*
		Port 2	5V 2A maximum for smartphone charging*
Power Consumption			DC: 5V, 1.24W, 406 BTU
Operating Temperature			32° to 104°F (0° to 40°C)
Storage Temperature			-4° to 140°F (-20° to 60°C)
Humidity			0 to 80% RH, Non-Condensing
Housing			Aluminum
Weight			0.84 lb. (0.38 kg)
Dimensions			5.63 x 4.69 x 0.96 in. (14.3 x 11.9 x 2.45 cm)

* Additional USB-C power adapter is required

Warranty and Product Registration

3-Year Limited Warranty

Seller warrants this product, if used in accordance with all applicable instructions, to be free from original defects in material and workmanship for a period of 3 years from the date of initial purchase. If the product should prove defective in material or workmanship within that period, Seller will repair or replace the product, at its sole discretion.

THIS WARRANTY DOES NOT APPLY TO NORMAL WEAR OR TO DAMAGE RESULTING FROM ACCIDENT, MISUSE, ABUSE OR NEGLIGENCE. SELLER MAKES NO EXPRESS WARRANTIES OTHER THAN THE WARRANTY EXPRESSLY SET FORTH HEREIN. EXCEPT TO THE EXTENT PROHIBITED BY APPLICABLE LAW, ALL IMPLIED WARRANTIES, INCLUDING ALL WARRANTIES OF MERCHANTABILITY OR FITNESS, ARE LIMITED IN DURATION TO THE WARRANTY PERIOD SET FORTH ABOVE; AND THIS WARRANTY EXPRESSLY EXCLUDES ALL INCIDENTAL AND CONSEQUENTIAL DAMAGES. (Some states do not allow limitations on how long an implied warranty lasts, and some states do not allow the exclusion or limitation of incidental or consequential damages, so the above limitations or exclusions may not apply to you. This warranty gives you specific legal rights, and you may have other rights which vary from jurisdiction to jurisdiction.)

WARNING: The individual user should take care to determine prior to use whether this device is suitable, adequate or safe for the use intended. Since individual applications are subject to great variation, the manufacturer makes no representation or warranty as to the suitability or fitness of these devices for any specific application.

Warranty and Product Registration

Product Registration

Visit triplite.com/warranty today to register your new Tripp Lite product. You'll be automatically entered into a drawing for a chance to win a FREE Tripp Lite product!*

**No purchase necessary. Void where prohibited. Some restrictions apply See website for details.*

Tripp Lite has a policy of continuous improvement. Specifications are subject to change without notice. Photos and illustrations may differ slightly from actual products.



1111 W. 35th Street, Chicago, IL 60609 USA • triplite.com/support